

Technical data sheet

Gutex Multiplex-top



GUTEX Multiplex-top is the tested rainproof sarking board up to 35 mm.

Ingredients

- Untreated fir and spruce
- 4.0 % PUR resin
- 1.5 % paraffin

Disposal

- Waste code numbers as per AVV 030105, 170201

Bulk density ρ [kg/m ³]	~ 220
Nominal thermal conductivity λ_D [W/mK]	0.045
Vapour diffusion μ	3
Compressive stress/strength [kPa]	≥ 200
Tensile strength perpendicular to the surface [kPa]	≥ 30
Short-term water absorption [kg/m ²]	≤ 1
Air flow resistivity [kPa s/m ²]	≥ 100
Specific heat capacity [J/kgK]	2100
Maximum working temperature [°C]	110
Fire reaction Euro Class as per EN 13501-1	E
Product standard	EN 13171
Board type as per EN 622-4	SB.E
Board designation	WF-EN 13171-T5-CS(10/Y)200-TR30-WS1,0-AF ₁₀₀ -MU3



Technical data sheet

Gutex Multiplex-top

Joint type	Tongue and groove	
Thickness [mm]	22	35
Length × width [mm × mm]	2500 × 750	
Actual coverage: Length × width [mm × mm]	2480 × 728	2480 × 722
Actual coverage: Square metres per board [m ²]	1.81	1.79
m ² /Piece(s)	1.87	
Weight per board [kg]	9.10	14.40
Weight per m ² [kg]	4.84	7.70
Piece(s)/Pallet	45	30
Square metres per pallet [m ²]	84.38	56.25
Weight per pallet [kg]	520	485
Nominal thermal resistance R _D [m ² K/W]	0.50	0.80
sd value [m]	0.07	0.11



Product information

Gutex Multiplex-top

Areas of use

- As a rainproof sub-roof
- As a cover board in combination with GUTEX Thermosafe-homogen for on-roof insulation
- Installation directly on the rafters

Advantages

- High dimensional accuracy for time-saving and simple installation
- Single-layer, homogeneous bulk density profile
- Windproof
- Rainproof from 15° roof pitch without additional covering or taping of the board joints
- Can be exposed to the elements for 3 months as a temporary roof
- No nail sealing tapes or nail seals necessary
- Additional thermal insulation
- Minimisation of thermal bridges
- Outstanding heat storage capacity → impressive summer heat protection
- Improvement of sound insulation
- Moisture-regulating
- Vapour-permeable
- Guarantee deposited with the Central Association of the German Roofing Trade
- Wood as the sustainable raw material → recyclable
- Manufactured in the direct vicinity of Switzerland (Waldshut, Black Forest)
- Ecologically safe (natureplus® certified)

Installation instructions

- Store and work with the boards in a dry place
- Install the boards with the labelled side facing outwards
- Adhere to rafter unit spacing:

Board thickness in mm	Max. rafter unit spacing in cm
22	85
28	90
35	100

- Install the boards horizontally; they must fit accurately and be joint-tight
- Gaps between rafters are not accessible
- Fasten immediately with counterlathing
- No nail sealing tapes or nail seals necessary
- Cross joints are not permitted
- Do not install damaged boards
- The boards are generally installed at right angles to the rafters
- Joint offset from row to row by at least 1 rafter unit spacing, but at least 40 cm

- Joints and penetrations must be taped rainproof with the GUTEX adhesive system
- Install with rising tongue
- The board cannot be statically supported
- GUTEX Multiplex-top is not a load-bearing component (e.g. snow loads)
- Increased levels of moisture inside must be avoided
- Rainwater run-off, especially during the construction phase, can contaminate adjacent building components through fibre abrasion or other impurities. Ensure appropriate water drainage.
- GUTEX wood fibre insulation boards can be exposed to temperatures of up to 110°C, even over a longer period of time. If higher temperatures are to be expected, e.g. with solar pipes, additional steps must be taken.
- The required minimum clearances from combustible building materials to chimneys etc. are specified in the relevant fire protection regulations and must be adhered to.
- Note the legal requirements for handling wood dust

Note for the following roof pitches:

< 15°	cover with suitable membrane
≥ 15°	no bonding of board joints necessary, provided the standard roof pitch is not undercut by more than 8°.

Hot air welding – guidelines

- No direct flame application; hot air only (hot air device)
- Set hot air blower temperature < 350°
- The hot air device must not be left in one place for longer than 7-10 sec
- If discolouration is seen on the surface of the wood fibre insulation board, the area must be checked and, if necessary, removed

These guidelines protect GUTEX boards (not including GUTEX Thermoflex or GUTEX Thermofibre) from spontaneous combustion; the guidelines for the membranes must also be followed.

Fastening tables when using sarking

The fasteners used must be galvanised at minimum.

For deviating designs, the 'Screw dimensioning' form can be found at www.gutex.de/service/bemessung-verbindungsmitel

GUTEX Multiplex-top ≤ 35 mm and building height ≤ 10 m inland								
Rafter unit spacing ≤ 85 cm Counterlathing 60×40			Spacing for Paslode 3.8×130 groove RoundDrive® (galvanised) in cm			Spacing for ITW clips SD 91120/BS 29120 (galvanised) in cm		
Roofing load kN/m ²	Snow kN/m ²	Wind zone	Roof pitch			Roof pitch		
			15°	30°	45°	15°	30°	45°
0,30	$\leq 0,85$	Wz 1	70	40	45	45	40	45
		Wz 2	50	40	45	35	35	30
		Wz 3	35	35	35	25	25	25
		Wz 4	25	25	25	20	15	15
0,60	$\leq 0,85$	Wz 1	60	30	30	55	30	30
		Wz 2	55	30	30	40	30	30
		Wz 3	40	30	30	25	25	25
		Wz 4	30	25	25	20	20	20
0,95	$\leq 0,85$	Wz 1	45	25	15	45	25	15
		Wz 2	45	25	15	45	25	15
		Wz 3	45	25	15	30	25	15
		Wz 4	30	25	15	20	20	15

Source: ITW: we cannot guarantee the accuracy of the information in the tables.

Details



Penetration joint

- 1** GUTEX Multiplex-top
- 2** GUTEX adhesive system
- 3** GUTEX caulking



Ridge

- 1** GUTEX Multiplex-top
- 2** Sarking
- 3** Counterlathing

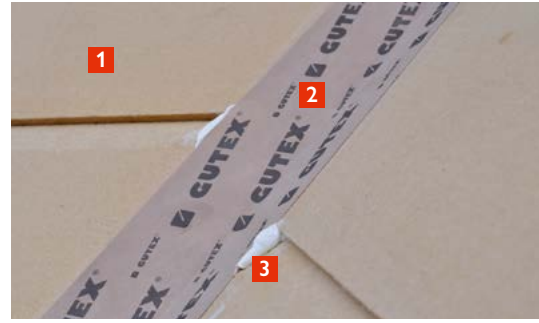
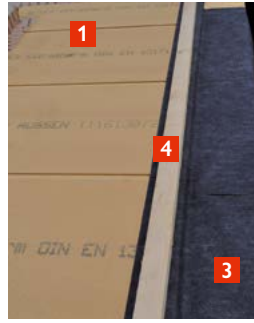

Verge

- 1 GUTEX Multiplex-top
- 2 GUTEX caulking
- 3 Sarking
- 4 Counterlathing

Valley

- 1 GUTEX Multiplex-top
- 2 GUTEX adhesive system
- 3 GUTEX caulking



Eaves 1. Variant

- 1 Canopy formwork
- 2 GUTEX Multiplex-top
- 3 Sarking
- 4 Rafter

Eaves 2. Variant

- 1 GUTEX Multiplex-top
- 2 Sarking
- 3 Counterlathing (doubled)

