



GUTEX Thermosafe-wd

TECHNICAL DATA SHEET



GUTEX Thermosafe-wd is the pressure-resistant wood fibre insulation board for interior floor and wall constructions with live loads of up to 5 kN/m².

Ingredients

- Untreated fir and spruce
- 4.0 % PUR resin

Disposal

- Waste code numbers as per AVV 030105, 170201

Bulk density ρ [kg/m ³]	~ 140
Nominal thermal conductivity λ_D [W/mK]	0.040
Vapour diffusion μ	3
Compressive stress/strength [kPa]	≥ 70
Compressibility with live loads ≤ 5 kPa [mm]	2
Air flow resistivity [kPa s/m ²]	≥ 100
Specific heat capacity [J/kgK]	2100
Maximum working temperature [°C]	110
Fire reaction Euro Class as per EN 13501-1	E
Product standard	EN 13171
Board designation	WF-EN 13171-T4-CP2-CS(10/Y)70-MU3-AF _r 100





GUTEX Thermosafe-wd

Detailed information

Joint type	Flush-mount			
Thickness [mm]	20	30	40	60
Length × width [mm × mm]	1250 × 600			
m ² /Piece(s)	0.75			
Weight per board [kg]	2.10	3.20	4.20	6.30
Weight per m ² [kg]	2.80	4.20	5.60	8.40
Piece(s)/Pallet	224	140	112	70
Square metres per pallet [m ²]	168.00	105.00	84.00	52.50
Weight per pallet [kg]	600	520	510	460
Nominal thermal resistance R _D [m ² K/W]	0.50	0.75	1.00	1.50
sd value [m]	0.06	0.09	0.12	0.18

Joint type	Flush-mount		
Thickness [mm]	80	100	120
Length × width [mm × mm]	1250 × 600		
m ² /Piece(s)	0.75		
Weight per board [kg]	8.40	10.50	12.60
Weight per m ² [kg]	11.20	14.00	16.80
Piece(s)/Pallet	56	42	36
Square metres per pallet [m ²]	42.00	31.50	27.00
Weight per pallet [kg]	490	470	
Nominal thermal resistance R _D [m ² K/W]	2.00	2.50	3.00
sd value [m]	0.24	0.30	0.36





GUTEX Thermosafe-wd

PRODUCT INFORMATION

Areas of use

- Insulation under screeds and floor coverings
- On-roof and between-rafter insulation
- Interior insulation of ceiling, wall, floor, or roof
- Insulation of timber frame and timber panel construction
- Insulation of the top floor ceiling

Advantages

- Outstanding thermal insulation
- Outstanding heat storage capacity → protection from heat in summer and cold in winter
- Improvement of sound insulation
- Moisture-regulating and steam vapour-permeable
- Able to withstand pressure
- Wood as the sustainable raw material → recyclable
- Manufactured in the direct vicinity of Switzerland (Waldshut, Black Forest)
- Ecologically safe (natureplus® certified)

Installation instructions

- Store and work with the boards in a dry place
- Use a staggered pattern with several layers
- Avoid cross joints
- The following are some of the tools that may be used to produce the cut:
 - GUTEX cutting blade for jigsaws
 - Festool sword saws
 - Mafell DSS 300 cc
 - Band or circular saws with extraction unit
- Note the legal requirements for handling wood dust
- Create a dry, level, and technically perfect substrate
- Protect from moisture
- Apply edge strips at the height of the entire structure

Maximum built-up height

Covering on GUTEX Thermosafe-wd	Maximum built-up height GUTEX Thermosafe-wd
Wet screed	140 mm
Mastic asphalt	140 mm
Chipboard ≥ 25 mm	140 mm
OSB board ≥ 22 mm	140 mm
GUTEX Thermosafe-nf	100 mm
Dry screed element ≥ 25 mm	100 mm
Prefinished engineered wood flooring ≥ 14 mm	30 mm
Laminate flooring ≥ 8 mm	20 mm



Floor structure

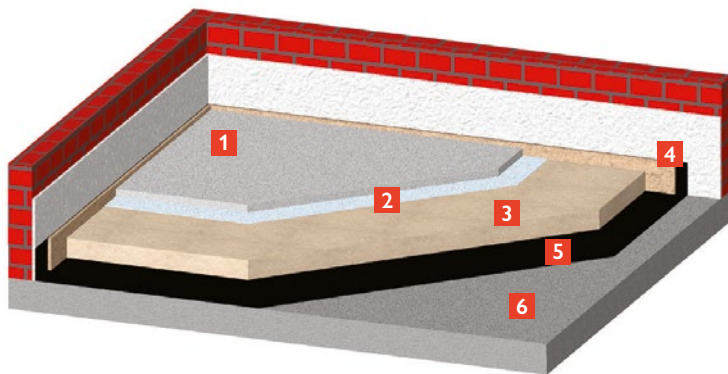

- 1 Wet screed
- 2 Moisture-protection film
- 3 GUTEX Thermosafe-wd
- 4 Edge strip
- 5 Moisture barrier as per 18195
- 6 Basement ceiling

Installation diagram

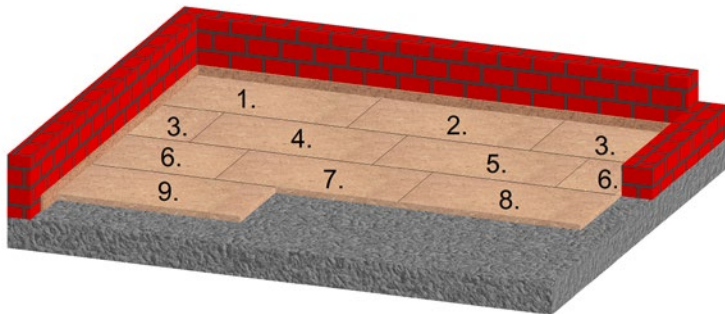

- Install GUTEX Thermosafe-wd in a bond pattern.
- The remaining piece in one installation row is placed at the beginning of the next row (see installation diagram)

